

## User Instructions

©2015 ADJ Products, LLC all rights reserved. Information, specifications, diagrams, images, and instructions herein are subject to change without notice. ADJ Products, LLC logo and identifying product names and numbers herein are trademarks of ADJ Products, LLC. Copyright protection claimed includes all forms and matters of copyrightable materials and information now allowed by statutory or judicial law or hereinafter granted. Product names used in this document may be trademarks or registered trademarks of their respective companies and are hereby acknowledged. All non-ADJ Products, LLC brands and product names are trademarks or registered trademarks of their respective companies.

**ADJ Products, LLC** and all affiliated companies hereby disclaim any and all liabilities for property, equipment, building, and electrical damages, injuries to any persons, and direct or indirect economic loss associated with the use or reliance of any information contained within this document, and/or as a result of the improper, unsafe, insufficient and negligent assembly, installation, rigging, and operation of this product.

Europe Energy Saving Notice  
Energy Saving Matters (EuP 2009/125/EC)  
Saving electric energy is a key to help protecting the environment. Please turn off all electrical products when they are not in use. To avoid power consumption in idle mode, disconnect all electrical equipment from power when not in use. Thank you!

Warlock	General Information
---------	---------------------

**Unpacking:** Thank you for purchasing the Warlock by ADJ Products, LLC. Every Warlock has been thoroughly tested and has been shipped in perfect operating condition. Carefully check the shipping carton for damage that may have occurred during shipping. If the carton appears to be damaged, carefully inspect your fixture for any damage and be sure all equipment necessary to operate the unit has arrived intact. In the event damage has been found or parts are missing, please contact our toll free customer support number for further instructions. Please do not return this unit to your dealer without contacting customer support first.

**Introduction:** The Warlock is a DMX intelligent LED barrel roller. The Warlock has three operating modes; sound active mode, show mode, and DMX controlled. The Warlock has 8 DMX channels. The Warlock can be set up as a stand alone fixture or in a Master/Slave configuration. *For best results use fog or special effects smoke to enhance the beams projections.*

**Customer Support:** ADJ Products, LLC provides a toll free customer support line, to provide help and to answer any question should you encounter problems during your set up or initial operation. You may also visit us on the web at [www.adj.com](http://www.adj.com) for any comments or suggestions. Service Hours are Monday through Friday 8:00 a.m. to 4:30 p.m. Pacific Standard Time.

Voice: (800) 322-6337  
 Fax: (323) 582-2941  
 E-mail: [support@americandj.com](mailto:support@americandj.com)

To purchase parts online visit <http://parts.americandj.com>

**Warning!** To prevent or reduce the risk of electrical shock or fire, do not expose this unit to rain or moisture.

**Warning!** *This may cause severe eye damage. Avoid looking directly into the light source at all times!*

Warlock	General Instructions
---------	----------------------

To optimize the performance of this product, please read these operating instructions carefully to familiarize yourself with the basic operations of this unit. These instructions contain important safety information regarding the use and maintenance of this unit. Please keep this manual with the unit, for future reference.

Warlock	Features
---------	----------

- 8 DMX Channels
- 3 Operating Modes - Sound Active, Show Mode, & DMX Control
- Internal Microphone
- Digital Display for Address and Function Setting
- 6 Preprogrammed Shows
- Power Cord Daisy Chain (See page 26)
- UC IR Compatible (Sold Separately)

Warlock	Warranty Registration
---------	-----------------------

The Warlock carries a 2 year (730 days) limited warranty. Please fill out the enclosed warranty card to validate your purchase and warranty. You may also register your product online at [www.americandj.com](http://www.americandj.com). All returned service items whether under warranty or not, must be freight pre-paid and accompany a return authorization (R.A.) number. If the unit is under warranty you must provide a copy of your proof of purchase invoice. Please contact ADJ customer support for a R.A. number.

Warlock	Handling Precautions
---------	----------------------

**Caution!** There are no user serviceable parts inside this unit. Do not attempt any repairs yourself, doing so will void your manufactures warranty. In the unlikely event your unit may require service please contact ADJ Products, LLC.

*During operation the housing may become extremely hot. Avoid touching the unit with bare hands while in use.*

*ADJ Products, LLC will not accept any liability for any resulting damages caused by the non-observance of this manual or any unauthorized modification to this unit.*

***For Your Own Personal Safety, Please Read and Understand This Manual Completely Before You Attempt To Install Or Operate This Unit!***

- To reduce the risk of electrical shock or fire, do not expose this unit rain or moisture
- Do not spill water or other liquids into or on to your unit.
- Do not attempt to operate this unit if the power cord has been frayed or broken.
- Do not attempt to remove or break off the ground prong from the electrical cord. This prong is used to reduce the risk of electrical shock and fire in case of an internal short.
- Disconnect from main power before making any type of connection.
- Do not remove the cover under any conditions. There are no user serviceable parts inside.
- Never operate this unit when it's cover is removed.
- Always be sure to mount this unit in an area that will allow proper ventilation. Allow about 6" (15cm) between this device and a wall.
- Do not attempt to operate this unit, if it becomes damaged.
- This unit is intended for indoor use only, use of this product outdoors voids all warranties.
- Always mount this unit in safe and stable matter.
- Power-supply cords should be routed so that they are not likely to be walked on or pinched by items placed upon or against them, paying particular attention to cords at plugs, convenience receptacles, and the point where they exit from the appliance.
- Cleaning -The fixture should be cleaned only as recommended by the manufacturer. See page 27 for cleaning details.
- Heat -This fixture should be situated away from heat sources such as radiators, heat registers, stoves, or other appliances (including amplifiers) that produce heat.
- The fixture should be serviced by qualified service personnel when:
  - A. Objects have fallen, or liquid has been spilled into the appliance.
  - B. The appliance has been exposed to rain or water.
  - C. The appliance does not appear to operate normally or exhibits a marked change in performance.

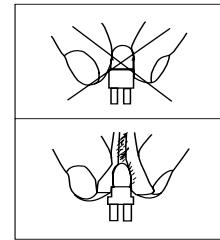

This fixture is fitted with a discharge lamp which is highly susceptible to damage if improperly handled. Never touch the lamp with your bare fingers as the oil from your hands will shorten lamp life. Also, never move the fixture until the lamps have had ample time to cool. Remember, lamps are not covered under warranty conditions.

This unit emits intense UV radiation which is harmful to the eyes and skin. The intense luminance of the lamp can cause severe damage to the retina. Never operate this unit without it's covers, these covers have been specially designed to shield against UV radiation.

***Epileptic Warning:*** Those suffering from epilepsy should avoid looking directly into the lamp at all times.

Avoid switching the fixture on and off repeatedly in short intervals as this will reduce lamp life and intensity.

To achieve the intensity associated with discharge lamps, these lamps use gas sealed in a high pressure environment to emit a brilliant output. Due to the high pressure involved with the construction of the lamp, the lamp may explode during prolonged extensive use. This risk is increased with age, added care is encouraged when dealing with older lamps. Extreme caution should be used when operating this or any fixture fitted with a gas discharge lamp. Never open this unit while in use.

**VERY IMPORTANT:** This is for your safety and the life length of the unit. The Philips® Platinum 2R Discharge lamp has lifetime of 6000 hours.

ADJ recommends periodically checking the lamp running time. See page 17 "Lamp Time". When the lamp reaches the 6000 hour mark, or close to it, we strongly suggest you switch the lamp out.

Clear the LAMP RUNNING TIME after you have replaced the lamp. See page 17 "Reset Lamp Time"

**Warning: DO NOT use this lamp more then 6000 hours. Using the lamp any longer then the set life could seriously damage your unit.**

## Warlock

## Mounting

When installing the unit, the trussing or area of installation must be able to hold 10 times the weight without any deformation. When installing the unit must be secured with a secondary safety attachment, e.g. and appropriate safety cable. Never stand directly below the unit when mounting, removing, or servicing the unit.

Overhead mounting requires extensive experience, including calculating working load limits, installation material being used, and periodic safety inspection of all installation material and unit. If you lack these qualifications, do not attempt the installation yourself.

These installaiton should be checked by a skilled person once a year.

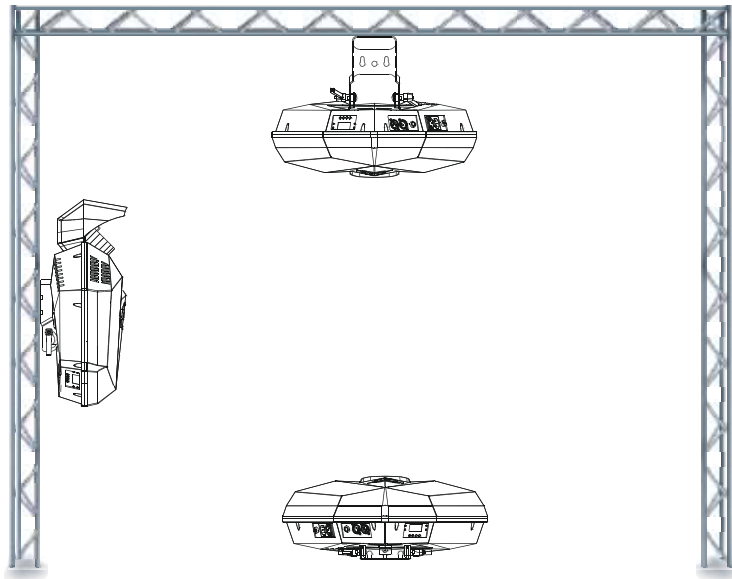

The Warlock is fully operational in three different mounting positions, hanging upside-down from a ceiling, mounted sideways on trussing, or set on a flat level surface. Be sure this fixture is kept at least 0.5m away from any flammable materials (decoration etc.). Always use and install the supplied safety cable as a safety measure to prevent accidental damage and/or injury in the event the clamp fails (see next page). Never use the carrying handles for secondary attachment.

## Warlock

## Mounting

**NOTICE:** The suitable enviromental temperature for this lighting fixture is between -25° C to 45° C. Do not place this lighting fixture in an enviroment where the temperatures are under or above the temperatures stated above. This will allow the fixture to run at its best and help prolong the fixture life.

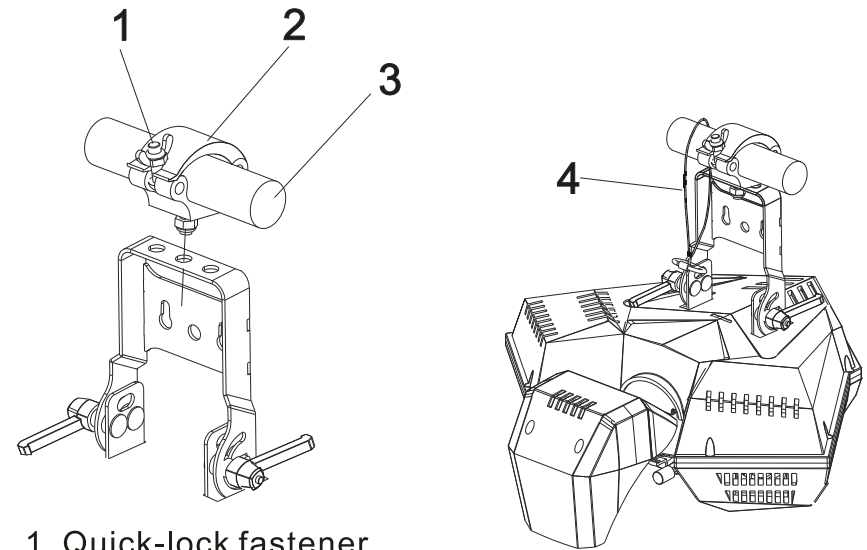

1. Quick-lock fastener
2. Clamp
3. Suspender
4. Safety Cable

Screw one clamp via a M12 screw and nut onto the supplied mounting bracket. Pull the safety-cable through the hole on the safety cable bracket that is attached to back of unit and over the trussing system or a safe fixation spot. Insert the end in the carabine and tighten the safety screw.



**Power Supply:** The ADJ Warlock contains an electronic ballast, which will auto sense the voltage when it is plugged into a power source. With this switch there is no need to worry about the correct power voltage, this unit can be plugged in anywhere.

**DMX-512:** DMX is short for Digital Multiplex. This is a universal protocol used by most lighting and controller manufactures as a form of communication between intelligent fixtures and controllers. A DMX controller sends DMX data instructions from the controller to the fixture. DMX data is sent as serial data that travels from fixture to fixture via the DATA "IN" and DATA "OUT" XLR terminals located on all DMX fixtures (most controllers only have a DATA "OUT" terminal).

**DMX Linking:** DMX is a language allowing all makes and models of different manufactures to be linked together and operate from a single controller, as long as all fixtures and the controller are DMX compliant. *To ensure proper DMX data transmission, when using several DMX fixtures try to use the shortest cable path possible. The order in which fixtures are connected in a DMX line does not influence the DMX addressing. For example; a fixture assigned a DMX address of 1 may be placed anywhere in a DMX line, at the beginning, at the end, or anywhere in the middle. Therefore, the first fixture controlled by the controller could be the last fixture in the chain. When a fixture is assigned a DMX address of 1, the DMX controller knows to send DATA assigned to address 1 to that unit, no matter where it is located in the DMX chain.*

**Data Cable (DMX Cable) Requirements (For DMX and Master/Slave Operation):** The Warlock can be controlled via DMX-512 protocol. The Warlock has 8 DMX channels. The DMX address is set electronically using the controls on the rear side panel of the unit. Your unit and your DMX controller require a approved DMX-512 110 Ohm Data cable for data input and data output (Figure 1). We recommend Accu-Cable DMX cables. If you are making your own cables, be sure to use standard 110-120 Ohm shielded cable (This cable may be purchased at almost all professional sound and lighting stores). Your cables should be made with a male and female XLR connector on either end of the cable. Also remember that DMX cable must be



Figure 1

daisy chained and cannot be split.

**Notice:** Be sure to follow figures two and three when making your own cables. Do not use the ground lug on the XLR connector. Do not connect the cable's shield conductor to the ground lug or allow the shield conductor to come in contact with the XLR's outer casing. Grounding the shield could cause a short circuit and erratic behavior.

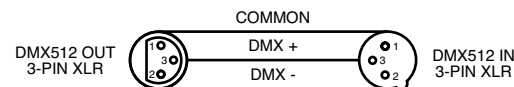

Figure 2

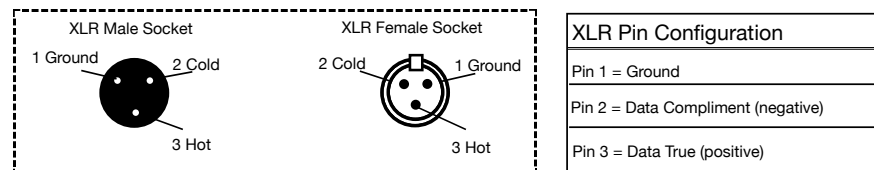

Figure 3

**Special Note: Line Termination.** When longer runs of cable are used, you may need to use a terminator on the last unit to avoid erratic behavior. A terminator is a 110-120 ohm 1/4 watt resistor which is connected between pins 2 and 3 of a male XLR connector (DATA + and DATA -). This unit is inserted in the female XLR connector of the last unit in your daisy chain to terminate the line. Using a cable terminator (ADJ part number Z-DMX/T) will decrease the possibilities of erratic behavior.



Termination reduces signal errors and avoids signal transmission problems and interference. It is always advisable to connect a DMX terminal, (Resistance 120 Ohm 1/4 W) between PIN 2 (DMX-) and PIN 3 (DMX +) of the last fixture.

Figure 4

**5-Pin XLR DMX Connectors.** Some manufactures use 5-pin DMX-512 data cables for DATA transmission in place of 3-pin. 5-pin DMX fixtures may be implemented in a 3-pin DMX line. When inserting standard 5-pin data cables in to a 3-pin line a cable adaptor must be used, these adaptors are readily available at most electric stores. The chart below details a proper cable conversion.

3-Pin XLR to 5-Pin XLR Conversion		
Conductor	3-Pin XLR Female (Out)	5-Pin XLR Male (In)
Ground/Shield	Pin 1	Pin 1
Data Compliment (- signal)	Pin 2	Pin 2
Data True (+ signal)	Pin 3	Pin 3
Not Used		Pin 4 - Do Not Use
Not Used		Pin 5 - Do Not Use

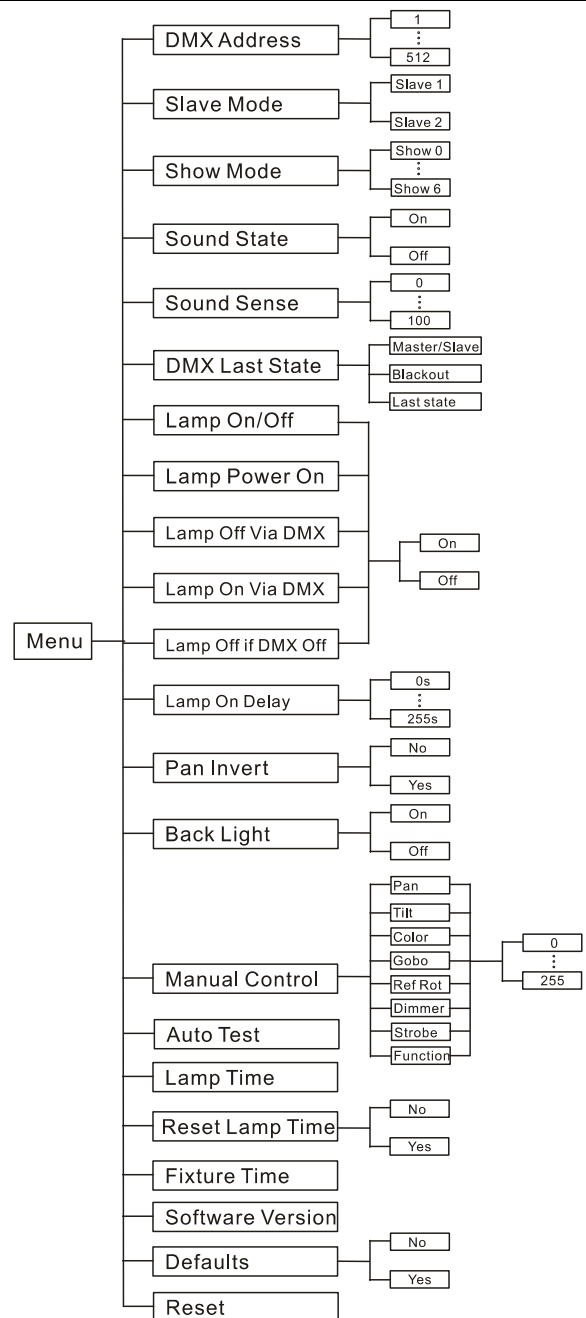

**System Menu:** When making adjustments press **ENTER** to confirm your setup then press and hold the **MENU** button for at least 3 seconds. To exit without making any adjustments press the **MENU** button. The display will lock after 30 seconds, press the **MENU** button for 3 seconds to unlock.

## DMX Address - Set the DMX Address -

1. Press the MENU button until “DMX Address” is displayed, press ENTER.
2. “X” will now be displayed, “X” represents the displayed address. Press the UP or DOWN buttons to find your desired address.
3. Press ENTER to confirm, and then press and hold the MENU button for at least three seconds to assign.

## Slave Mode - This will let you set unit as a master or slave in a master/slave configuration.

1. Press the MENU button until “Slave Mode” is displayed, press ENTER. Either “Slave 1” or “Slave 2” will be displayed.
2. Press the UP or DOWN buttons until your desired setting is displayed, then press ENTER to confirm.

**NOTE:** In a Master/Slave configuration you can make one fixture the Master and then set the next fixture to “Slave 2”, the fixtures will now have contrast movement to each other.

## Show Mode - Show modes 0 - 6 (Factory Shows).

1. Press the MENU button until “Show Mode” is displayed, press ENTER.
2. “Show X” will now be displayed, “X” representing a number between 0-6. Programs 1-6 are factory programs, while “Show

0” is random mode. Press the UP or DOWN buttons to find your desired show and press ENTER to select your show.

## Sound State - In this mode the unit will run in sound active mode.

1. Press the MENU button until “Sound State” is displayed, press ENTER.
2. Either “On” or “Off” will now be displayed. Use the UP or DOWN buttons to toggle between “On” and “Off”.
3. Press ENTER to confirm your selection, then press and hold the MENU button to activate.

## Sound Sense - In this mode you can adjust the sound sensitivity of the sound active mode.

1. Press the MENU button until “Sound Sense” is displayed, press ENTER.
2. Press the UP or DOWN buttons to adjust the sensitivity level. The sensitivity level can be adjusted between 0 (the lowest) and 100 (most sensitive).
3. Press ENTER to set your desired level.

## DMX Last State - This mode can be used as a precaution mode, that in case the DMX signal is lost, the operating mode chosen in the setup is the running mode the fixture will go into when the DMX signal is lost. You can also set this as the operating mode you would like the unit to return to when power is applied.

1. Press the MENU button until “DMX State” is displayed, press ENTER.
2. Either “Master/Slave”, “Blackout”, or “Last State” will be dis-

played. Choose an operating mode you would like the unit to start up in when power is applied or the DMX signal is lost.

- Master/Slave - If the DMX signal is lost or power is applied, the unit will automatically go into Master Slave mode.
- Blackout - If the DMX signal is lost or power is applied, the unit will automatically go into stand by mode.
- Last State - If the DMX signal is lost the fixture will stay in the last DMX set up. If power is applied and this mode is set, the unit will automatically go into the last DMX set up.

3. Press ENTER to confirm your desired set up.

### **Lamp On/Off - With this function you can turn the lamp on or off via the control panel.**

1. Press the MENU button until "Lamp On/Off" is displayed, press ENTER.
2. Either "ON" or "OFF" will now be displayed. Press the UP or DOWN buttons to select "ON" to turn the lamp on, or "OFF" to shut the lamp off.
3. Press ENTER to confirm.

### **Lamp Power On - With this function you can turn the lamp on or off via the control panel.**

1. Press the MENU button until "Lamp Power On" is displayed, press ENTER.
2. Either "ON" or "OFF" will now be displayed. Press the UP or DOWN buttons to select "ON" to turn the lamp on, or "OFF" to shut the lamp off.
3. Press ENTER to confirm.

### **Lamp Off Via DMX - With this function you can turn the lamp off using a DMX controller.**

1. Press the MENU button until "Lamp Off Via DMX" is displayed, press ENTER.
2. Either "ON" or "OFF" will now be displayed. Press the UP or DOWN buttons to select "ON" to turn the lamp on, or "OFF" to shut the lamp off.
3. Press ENTER to confirm.

### **Lamp On Via DMX - With this function you can turn the lamp on using a DMX controller.**

1. Press the MENU button until "Lamp On Via DMX" is displayed, press ENTER.
2. Either "ON" or "OFF" will now be displayed. Press the UP or DOWN buttons to select "ON" to turn the lamp on, or "OFF" to shut the lamp off.
3. Press ENTER to confirm.

### **Lamp Off if DMX OFF - With this function the lamp will turn off if the DMX signal is missing.**

1. Press the MENU button until "Lamp Off if DMX OFF" is displayed, press ENTER.
2. Either "ON" or "OFF" will now be displayed. Press the UP or DOWN buttons to select "ON" to turn the lamp on, or "OFF" to shut the lamp off.
3. Press ENTER to confirm.

## Lamp On Delay - With this function you set a delay time for the lamp to light.

1. Press the MENU button until "Lamp On Delay" is displayed, press ENTER.
2. A number between 0s-255s will be displayed. Use the UP and DOWN buttons to adjust the delay time to your desire.
3. Press ENTER to confirm.

## Pan Invert - Pan Inversion

1. Press the MENU button until "Pan Invert" is displayed, press ENTER. Either "Yes" or "No" will be displayed.
2. To activate the Pan inversion press the UP or DOWN buttons until "Yes" is displayed, press ENTER to confirm. To deactivate Pan inversion, select "No" and press Enter.

## Back Light - With this function you can make the backlight automatically turn off after one minute.

1. Press the MENU button until "Back Light" is displayed, press ENTER.
2. Either "ON" or "OFF" will now be displayed. Press the UP or DOWN buttons to select "ON" to keep the backlight on at all times, or "OFF" to allow the backlight to turn off after 2 minutes. Press any button to turn the backlight on again.
3. Press ENTER to confirm.

## Auto Test - This function will run a self test program.

1. Press the MENU button until "Auto Test" is displayed, press ENTER.

2. The fixture will now run a self test. Press the MENU button to exit.

## Manual Control - With this function you can manually test the individual features.

1. Press the MENU button until "Manual Control" is displayed, press ENTER.
2. Use the UP or DOWN buttons to find the functions that you wish to test.
3. Once you find a function you wish to test, press the ENTER button, the displayed value will begin to flash. You can now adjust the values by pressing the UP and DOWN buttons. Once you have finished testing press the ENTER button.
4. To exit the manual test mode, press the MENU button.

## Lamp Time - With this function you can check the lamp running time.

1. Press the MENU button until "Lamp Time" is displayed, press ENTER.
2. The current lamp running time will now be displayed, press the MENU button to exit.

## Reset Lamp Time - With this function you can clear the lamp running time. This should be done everytime you change out the lamp.

1. Press the MENU button until "Reset Lamp Time" is displayed, press ENTER.
2. Press the UP or DOWN buttons so that "Yes" is displayed and press ENTER to clear the lamp running time.

## Fixture Time - With this function you can display the running time of the unit.

1. Press the MENU button until “Function Hours” is displayed, press ENTER.
2. The running time of the fixture will now be displayed. Press MENU to exit.

## Software Version - This will display the software version.

1. Tap the MENU button until “Software Version” is displayed. Press the ENTER button and the software version will be displayed.
2. Press the MENU button to leave this function.

## Defaults - This will reset the unit to its default settings.

1. Tap the MENU button until “Defaults” is displayed. Press the ENTER button and either “Yes” or “No” will be displayed.
2. Press the UP or DOWN buttons so that either “Yes” (reset to default) or “No” (do not reset to default) and press ENTER to confirm.

## Restart - Use this function to reset the unit.

1. Tap the MENU button until “Restart” is displayed, press ENTER.
2. The fixture will now reset.

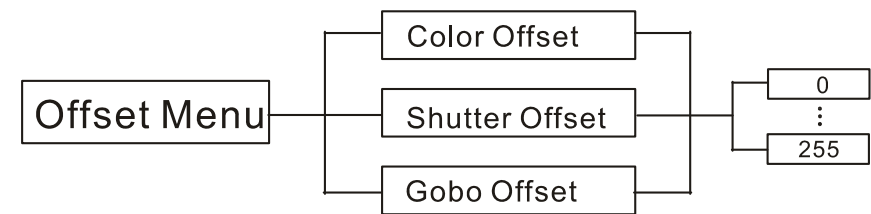

To enter the offset adjustment submenu, press the ENTER button for at least 5 seconds. In this submenu you are able to adjust the original position of the gobo wheel, shutter, and color wheel.

## Color Offset - Adjustment of the color wheel.

1. Press the ENTER button for at least 5 seconds, then press the UP or DOWN buttons so that “Color Offset” is displayed, press ENTER.
2. Use the UP and DOWN buttons to make your adjustments, and then press ENTER to confirm. Press the MENU button for one second to exit.

## Shutter Offset - Adjustment of the shutter.

1. Press the ENTER button for at least 5 seconds, then press the UP or DOWN buttons so that “Shutter Offset” is displayed, press ENTER.
2. Use the UP and DOWN buttons to make your adjustments, and then press ENTER to confirm. Press the MENU button for one second to exit.

## Gobo Offset - Adjustment of the gobo wheel.

1. Press the ENTER button for at least 5 seconds, then press the UP or DOWN buttons so that “Gobo Offset” is displayed, press ENTER.
2. Use the UP and DOWN buttons to make your adjustments, and then press ENTER to confirm. Press the MENU button for one second to exit.



## Warlock

## Operation

**Operating Modes:** The Warlock can operate in three different modes. In each mode you can run the fixture as a stand alone fixture or in a master/slave configuration.

### • Sound Active mode -

The fixture will react to sound, chasing through the built-in programs.

### • Show mode -

The fixture will run one of 6 shows.

### • DMX control mode -

This function will allow you to control each individual fixtures traits with a standard DMX-512 controller.

**Universal DMX Control:** This function allows you to use a universal DMX-512 controller to control the pan/tilt, colors, gobos, reflector, strobe and master dimmer. A DMX controller allows you to create unique programs tailored to your individual needs.

1. The Warlock has 8 DMX channels. See pages 23-25 for detailed description of the DMX values, and traits.
2. To control your fixture in DMX mode, follow the set-up procedures on pages 8-10 as well as the set-up specifications that are included with your DMX controller.
3. Use your DMX controller's faders to control the various DMX fixture traits.
4. Follow the instructions on page 12 to set your DMX address.
5. For longer cable runs (more than a 100 feet) use a terminator on the last fixture.
6. For help operating in DMX mode consult the manual included with your DMX controller.

**Sound Active Mode:** This mode allows either a single unit or several units linked together, to run to the beat of the music.

1. Press the MENU button until "**Sound State**" is displayed, and press ENTER. Press the UP or DOWN buttons so that "**ON**" is displayed and press ENTER.
2. To adjust the sound sensitivity level press the MENU button until "**Sound Sense**" is displayed, and press ENTER. Use the UP or DOWN buttons to adjust the sensitivity level, "0" being least sensitive, "100" being the most sensitive. Press ENTER to set your level.

## Warlock

## Operation

**Show Mode:** This mode allows either a single unit or several units linked together, to run one of 6 shows that you choose. Show mode can run with or without sound active mode.

1. Press the MENU button until "**Show Mode**" is displayed, and press ENTER.
2. Press the UP or DOWN buttons until you find your desired show, and press ENTER, then press and hold the MENU button for at least 3 seconds to activate. After you have set your desired show show, it can be changed at any time using the UP or DOWN buttons.

## Warlock

## Master-Slave Set Up

**Master-Slave Configuration** This function will allow you to link up to 16 units together and operate without a controller. The units will be sound activated. In a Master-Slave set up one unit will act as the controlling unit and the others will react to the controlling units programs. Any unit can act as a Master or as a Slave.

1. Using approved DMX data cables, daisy chain your units together via the XLR connector on the rear of the units. Remember the Male XLR connector is the input and the Female XLR connector is the output. The first unit in the chain (master) will use the female XLR connector only - The last unit in the chain will use the male XLR connector only. For longer cable runs we suggest a terminator at the last fixture.
2. Set your "Master" unit to your desired operating mode.
4. On the "Slave units" press the MENU button until "**Slave Mode**" is displayed, and press ENTER. Choose either "**Slave 1**" or "**Slave 2**" and press ENTER. See page 12 for more info.
5. The slave units will now follow the Master unit.

## Warlock UC IR Remote Control

The optional UC-IR infrared remote (sold separately) has many different functions and gives you complete control of your Warlock. To control the your desired fixture you must aim the controller at the front of the fixture and be no more the 30 feet away.

**STAND BY** - Pressing this button will blackout the fixture.

**FULL ON** - Press and hold this button to show full intensity. When this button is released the intensity will return to normal

**FADE/GOBO** - Press this button and then use buttons 1-9 to select the 1 of 9 gobos. To select gobo 10, press the FADE/GOBO button twice. To select gobo 11, press button #1 twice. To select gobo 12, press button #2 twice.

**COLOR** - Press this button and then use buttons 1-9 to select the 1 of 9 colors. To select color 10, press the COLOR button twice. To select color 11, press button #1 twice. To select color 12, press button #2 twice.

**STROBE** - Press this button for synchronous strobe, asynchronous, and sound active strobe.

**SOUND ON & OFF** - These buttons activate and deactivate the sound active mode.

**SHOW 0** - Press this button to activate show mode. Use buttons 0-6 to select your desired show. Show 0 is random show.

**“DIMMER +” and “DIMMER -”** - These buttons are used to adjust the output intensity.

Warlock		DMX Traits & Values
Channel	Value	Function
1	0 - 255	PAN
2	0 - 9 10 - 120 121 - 134 135 - 245 246 - 255	TILT STOP CLOCKWISE FAST - SLOW STOP COUNTER CLOCKWISE FAST - SLOW STOP
3	0 - 8 9 - 17 18 - 26 27 - 35 36 - 44 45 - 53 54 - 62 63 - 71 72 - 80 81 - 89 90 - 98 99 - 107 108 - 127 128 - 255	COLORS WHITE COLOR 1 COLOR 2 COLOR 3 COLOR 4 COLOR 5 COLOR 6 COLOR 7 COLOR 8 COLOR 9 COLOR 10 COLOR 11 COLOR 12 RAINBOW EFFECT SLOW - FAST
3	0 - 8 9 10 - 17 18 19 - 26 27 28 - 35 36 37 - 44 45 46 - 53 54 55 - 62 63	*COLORS* WHITE - COLOR 1 COLOR 1 COLOR 1 - COLOR 2 COLOR 2 COLOR 2 - COLOR 3 COLOR 3 COLOR 3 - COLOR 4 COLOR 4 COLOR 4 - COLOR 5 COLOR 5 COLOR 5 - COLOR 6 COLOR 6 COLOR 6 - COLOR 7 COLOR 7

Warlock DMX Traits & Values		
Channel	Value	Function
3		*COLORS*
	64 - 71	COLOR 7 - COLOR 8
	72	COLOR 8
	73 - 80	COLOR 8 - COLOR 9
	81	COLOR 9
	82 - 89	COLOR 9 - COLOR 10
	90	COLOR 10
	91 - 98	COLOR 10 - COLOR 11
	99	COLOR 11
	100 - 107	COLOR 11 - COLOR 12
	108 - 127	COLOR 12
4	128 - 255	RAINBOW EFFECT SLOW - FAST
		GOBOS
	0 - 4	OPEN
	5 - 9	GOBO 1
	10 - 14	GOBO 2
	15 - 19	GOBO 3
	20 - 24	GOBO 4
	25 - 29	GOBO 5
	30 - 34	GOBO 6
	35 - 39	GOBO 7
	40 - 44	GOBO 8
	45 - 49	GOBO 9
	50 - 54	GOBO 10
	55 - 59	GOBO 11
	60 - 64	GOBO 12
5	65 - 127	GOBO ANIMATION
	128 - 255	GOBO WHEEL ROTATION SLOW - FAST
		REFLECTOR ROTATION
5	0 - 9	STOP
	10 - 120	CLOCKWISE ROTATION FAST - SLOW
	121 - 134	STOP
	135 - 245	COUNTER CLOCKWISE ROTATION
		FAST - SLOW
	246 - 255	STOP

Warlock DMX Traits & Values		
Channel	Value	Function
6		SHUTTER
	0 - 7	BLACKOUT
	8 - 15	OPEN
	16 - 131	STROBING SLOW - FAST
	132 - 139	OPEN
	140 - 181	FAST OPEN - SLOW CLOSE
	182 - 189	OPEN
	190 - 231	FAST CLOSE - SLOW OPEN
	232 - 239	OPEN
	240 - 247	RANDOM STROBE
7	248 - 255	OPEN
		MASTER DIMMER
8	0 - 255	0% - 100%
		SPECIAL FUNCTIONS
	0 - 29	NO FUNCTION
	30 - 39	ENABLE COLOR WHEEL TO ANY POSITION*
	40 - 59	LAMP ON
	60 - 79	LAMP OFF
	80 - 84	ALL MOTORS RESET
	85 - 87	PAN/TILT MOTORS RESET
	88 - 90	COLOR WHEEL MOTOR RESET
	91 - 93	GOBO WHEEL MOTOR RESET
	94 - 96	SHUTTER/DIMMER MOTOR RESET
	97 - 99	OTHER MOTORS RESET
	100 - 109	ENABLE BLACKOUT WITH PAN/TILT MOVEMENT
	110 - 119	ENABLE BLACKOUT WITH COLOR CHANGE
	120 - 129	ENABLE BLACKOUT WITH GOBO CHANGE
	130 - 139	ENABLE BLACKOUT WITH ANY CHANGE
	140 - 255	NO FUNCTION

\*When Channel 8 is between the values of 30-39, the second Channel 3 split color values are used.

## Warlock

## Manual Focus

The Warlock can be manually focused using the knob located on the front of the unit directly in front of the lens. Turn the knob clockwise and counter-clockwise until your desired focus is reached.

## Warlock

## Power Cord Daisy Chain

**With this feature you can connect the fixtures to one another using the IEC input and output sockets. The quantity that can be connected is 3 fixtures maximum for 120V and 3 fixtures maximum for 240V. After the maximum fixtures has been reached you will need to use a new power outlet. They must be the same fixtures. DO NOT mix fixtures.**

## Warlock

## Photometric Chart

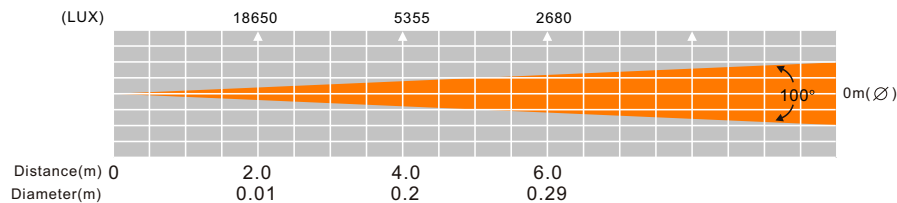

## Warlock

## Fuse Replacement

Locate the fuse holder is located at the rear of unit next to the power cord. Using a phillips head screwdriver, remove the fuse holder. Remove the used fuse and replace with a matching fuse. Insert the fuse holder and fuse into the unit and secure the fuse holder.

## Warlock

## Cleaning

**Fixture Cleaning:** Due to fog residue, smoke, and dust cleaning the internal and external optical lenses and mirror should be carried out periodically to optimize light output. Cleaning frequency depends on the environment in which the fixture operates (i.e. smoke, fog residue, dust, dew). In heavy club use we recommend cleaning on a monthly basis. Periodic cleaning will ensure longevity, and crisp output.

1. Use normal glass cleaner and a soft cloth to wipe down the outside casing.
2. Use a brush to wipe down the cooling vents and fan grill.
3. Clean the external optics with glass cleaner and a soft cloth every 20 days.
4. Clean the internal optics with glass cleaner and a soft cloth every 30-60 days.
5. Always be sure to dry all parts completely before plugging the unit back in.

## Warlock

## Trouble Shooting

**Trouble Shooting:** Listed below are a few common problems that you may encounter, with solutions.

### **No light output from the unit;**

1. Be sure the external fuse has not blown. The fuse is located next to the power cord connection.
2. Be sure the fuse holder is completely and properly seated.

### **Unit does not respond to sound;**

1. Low frequencies (bass) should cause the unit to react to sound. Tapping on the microphone, quiet or high pitched sounds may not activate the unit.

## MANUFACTURER'S LIMITED WARRANTY

- A. ADJ Products, LLC hereby warrants, to the original purchaser, ADJ Products, LLC products to be free of manufacturing defects in material and workmanship for a prescribed period from the date of purchase (see specific warranty period on reverse). This warranty shall be valid only if the product is purchased within the United States of America, including possessions and territories. It is the owner's responsibility to establish the date and place of purchase by acceptable evidence, at the time service is sought.
- B. **For warranty service you must obtain a Return Authorization number (RA#) before sending back the product—please contact ADJ Products, LLC Service Department at 800-322-6337.** Send the product only to the ADJ Products, LLC factory. All shipping charges must be pre-paid. If the requested repairs or service (including parts replacement) are within the terms of this warranty, ADJ Products, LLC will pay return shipping charges only to a designated point within the United States. If the entire instrument is sent, it must be shipped in its original package. No accessories should be shipped with the product. If any accessories are shipped with the product, ADJ Products, LLC shall have no liability whatsoever for loss of or damage to any such accessories, nor for the safe return thereof.
- C. This warranty is void if the serial number has been altered or removed; if the product is modified in any manner which ADJ Products, LLC concludes, after inspection, affects the reliability of the product; if the product has been repaired or serviced by anyone other than the ADJ Products, LLC factory unless prior written authorization was issued to purchaser by ADJ Products, LLC; if the product is damaged because not properly maintained as set forth in the instruction manual.
- D. This is not a service contract, and this warranty does not include maintenance, cleaning or periodic check up. During the period specified above, ADJ Products, LLC will replace defective parts at its expense with new or refurbished parts, and will absorb all expenses for warranty service and repair labor by reason of defects in material or workmanship. The sole responsibility of ADJ Products, LLC under this warranty shall be limited to the repair of the product, or replacement thereof, including parts, at the sole discretion of ADJ Products, LLC. All products covered by this warranty were manufactured after August 15, 2012, and bear indentifying marks to that effect.
- E. ADJ Products, LLC reserves the right to make changes in design and/or improvements upon its products without any obligation to include these changes in any products theretofore manufactured.

No warranty, whether expressed or implied, is given or made with respect to any accessory supplied with products described above. Except to the extent prohibited by applicable law, all implied warranties made by ADJ Products, LLC in connection with this product, including warranties of merchantability or fitness, are limited in duration to the warranty period set forth above. And no warranties, whether expressed or implied, including warranties of merchantability or fitness, shall apply to this product after said period has expired. The consumer's and/or Dealer's sole remedy shall be such repair or replacement as is expressly provided above; and under no circumstances shall ADJ Products, LLC be liable for any loss or damage, direct or consequential, arising out of the use of, or inability to use, this product.

This warranty is the only written warranty applicable to ADJ Products, LLC Products and supersedes all prior warranties and written descriptions of warranty terms and conditions heretofore published.

## MANUFACTURER'S LIMITED WARRANTY PERIODS:

- **Lighting Products = 1-year (365 days) Limited Warranty** (Such as: Special Effect Lighting, Intelligent Lighting, UV lighting, Strobos, Fog Machines, Bubble Machines, Mirror Balls, Par Cans, Trussing, Lighting Stands etc. excluding LED and lamps)
  - **Laser Products = 1 Year (365 Days) Limited Warranty** (excluding laser diodes which have a 6 month limited warranty)
  - **L.E.D. Products = 2-year (730 days) Limited Warranty** (excluding motors, PCB boards, and power supplies, which have a 1-year (365 day Limited Warranty) batteries which have a 180 day limited warranty). Only the L.E.D.s carry a 2-year warranty (excluding StarTec Series which carries a 90 Day Limited Warranty)
  - **ADJ DMX Controllers = 2 Year (730 Days) Limited Warranty** (excluding faders and tact switches)
- ADJ Products, LLC - [www.adj.com](http://www.adj.com) - Warlock Instruction Manual Page 28

Warlock	Specifications
<b>Model:</b>	<b>Warlock</b>
<b>Voltage:</b>	100V ~ 240V/50~60Hz
<b>Lamp:</b>	Philips® Platinum MSD 2R Discharge Lamp 132W, 8,000°K - 6,000 hr. average long life
<b>Power Consumption:</b>	202W
<b>Power Cord Daisy Chain:</b>	3 Fixtures Max. (120V) 6 Fixtures Max. (230V)
<b>Dimensions:</b>	20.25"(L) x 20.25"(W) x 14"(H) 512 x 516 x 354mm
<b>Weight:</b>	22 Lbs. / 10 kgs.
<b>Beam Angle:</b>	100 Degrees
<b>Fuse:</b>	7 Amp
<b>Duty Cycle:</b>	None
<b>DMX:</b>	8 DMX Channels
<b>Colors:</b>	12 Colors + White w/ Split Colors
<b>Sound Active:</b>	Yes
<b>Working Position:</b>	Any Safe, Secure Position
<b>Warranty:</b>	2 Year (730 days)

**Auto Sensing Voltage:** *This fixture contains an electronic ballast, which will auto sense the voltage when it is plugged into the power source.*

**Please Note:** *Specifications and improvements in the design of this unit and this manual are subject to change without any prior written notice.*

ADJ Products, LLC  
6122 S. Eastern Ave. Los Angeles, CA 90040 USA  
Tel: 323-582-2650 / Fax: 323-725-6100  
Web: [www.adj.com](http://www.adj.com) / E-mail: [info@americandj.com](mailto:info@americandj.com)

A.D.J. Supply Europe B.V.  
Junostraat 2  
6468 EW Kerkrade  
The Netherlands

Follow Us On:



[facebook.com/americandj](https://facebook.com/americandj)  
[twitter.com/americandj](https://twitter.com/americandj)  
[youtube.com/adjlighting](https://youtube.com/adjlighting)

[service@adjgroup.eu](mailto:service@adjgroup.eu) / [www.adj.eu](http://www.adj.eu)  
Tel: +31 45 546 85 00 / Fax: +31 45 546 85 99